

This map is reproduced from Ordnance Survey material with the permission of Ordnance Survey on behalf of the Controller of Her Majesty's Stationery Office © Crown copyright. Unauthorised reproduction infringes Crown copyright and may lead to prosecution of civil proceedings. Stockport Metropolitan Borough Council 100019571 2012

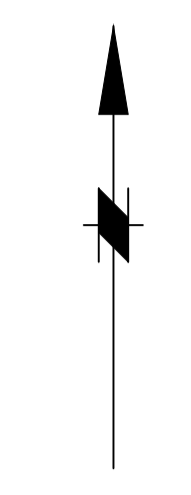

KEY

- PROPOSED CARRIAGEWAY
- PROPOSED CENTRAL RESERVE
- PROPOSED FOOTWAY/SHARED USE FACILITY/BRIDLEWAY
- PROPOSED FARMERS TRACK
- PROPOSED VERGE
- PROPOSED ENGINEERED EARTHWORKS
- PROPOSED ATTENUATION PONDS
- PROPOSED WATERCOURSE DIVERSION
- PROPOSED STRUCTURE
- EXISTING PUBLIC RIGHTS OF WAY
- EXISTING PUBLIC RIGHTS OF WAY STOPPED UP
- FENCING LEGEND**
- PROPOSED 1.8m HIGH ACOUSTIC FENCING REFER TO DETAIL ON DRG
- PROPOSED 3.0m HIGH ACOUSTIC FENCING REFER TO DETAIL ON DRG
- PROPOSED TIMBER POST AND FOUR RAIL FENCING REFER TO STANDARD
- PROPOSED 1.8m HIGH SECURITY FENCE
- PROPOSED 4.0m HIGH BALL STOP MESH FENCE
- PROPOSED TEMPORARY FENCE
- PROPOSED GATE
- PROPOSED STREET LIGHTING COLUMNS

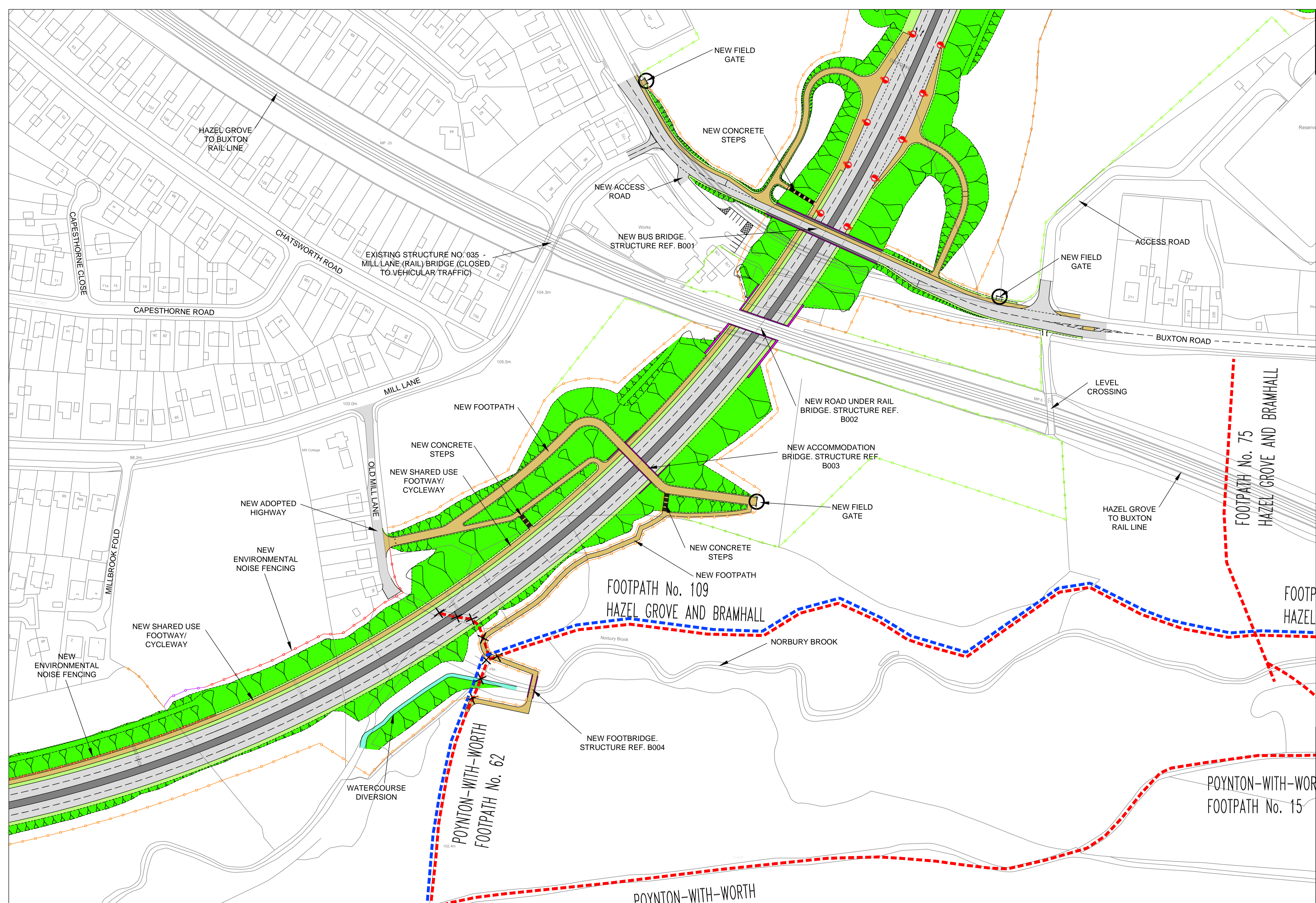
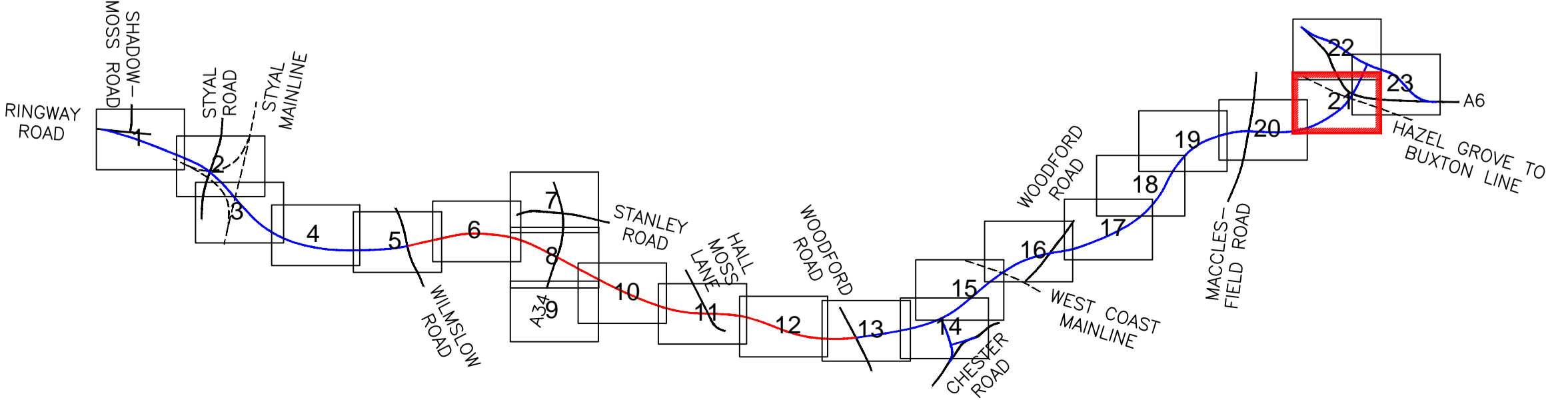

Rev.	Drawn	Checked	Date	Revision Details

www.semms.info

Jim McMahon BS: C.Eng. MICE
SERVICE DIRECTOR, MAJOR PROJECTS

STOPFORD HOUSE
STOPFORD ST. SUE
TEL : 0161 474 4351
FAX : 0161 474 4533

Job Title
A6 - MANCHESTER AIRPORT RELIEF ROAD

Drawing Title
PLANNING APPLICATION BLOCK PLANS PROPOSED SHEET 21

Drawn	Engineer	Checked	Approved
SEB/DP	SP	NH	AB
Date	Date	Date	Date
03.10.13	03.10.13	03.10.13	03.10.13
Size	Scale		
A1	1:1000		
SCG No.	Filename		

Drawing No. 1007/3D/DF7/A6-MA/PABP/P/042 Revision